

## MEASURES









DIMENSIONS H x W x D	873x1000x467 mm
GROSS/NET WEIGHT	160/150 kg
FIREWOOD ENTRANCE	920x430 mm
SMOKE FLUE	Ø 200 mm Top
EXTERNAL AIR INTAKE	Ø 80 mm

## CHARACTERISTICS

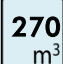
CAST IRON GRILL	
TWO-SIDED PANORAMIC VISION	
STEEL BODY SHEET	8,9 KW
NOMINAL HEAT OUTPUT	80,8 %
EFFICIENCY	0,10 %
CO EMISSIONS	800°C
HEAT RESISTANT PAINT	750°C

## PRODUCT PLUS

### ECODESIGN

-  EXTERNAL AIR INTAKE
-  WOOD LOGS UP TO 90 CM
-  270 m<sup>3</sup> HEATING VOLUME
-  CLEAN GLASS SYSTEM
-  DOUBLE COMBUSTION
-  DOUBLE LOCK
-  PRINTED GLASS
-  DOUBLE STEEL BODY SHEET OF 6+3 MM

EAN 8426964243604  
REF. 24360



SWING EN

# SWING EcoDesign

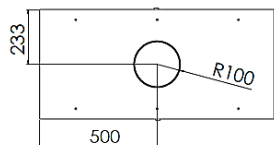
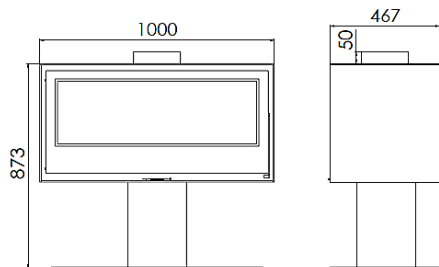

BlmSchV2

